

Instruction Manual

Manual Tube Bender

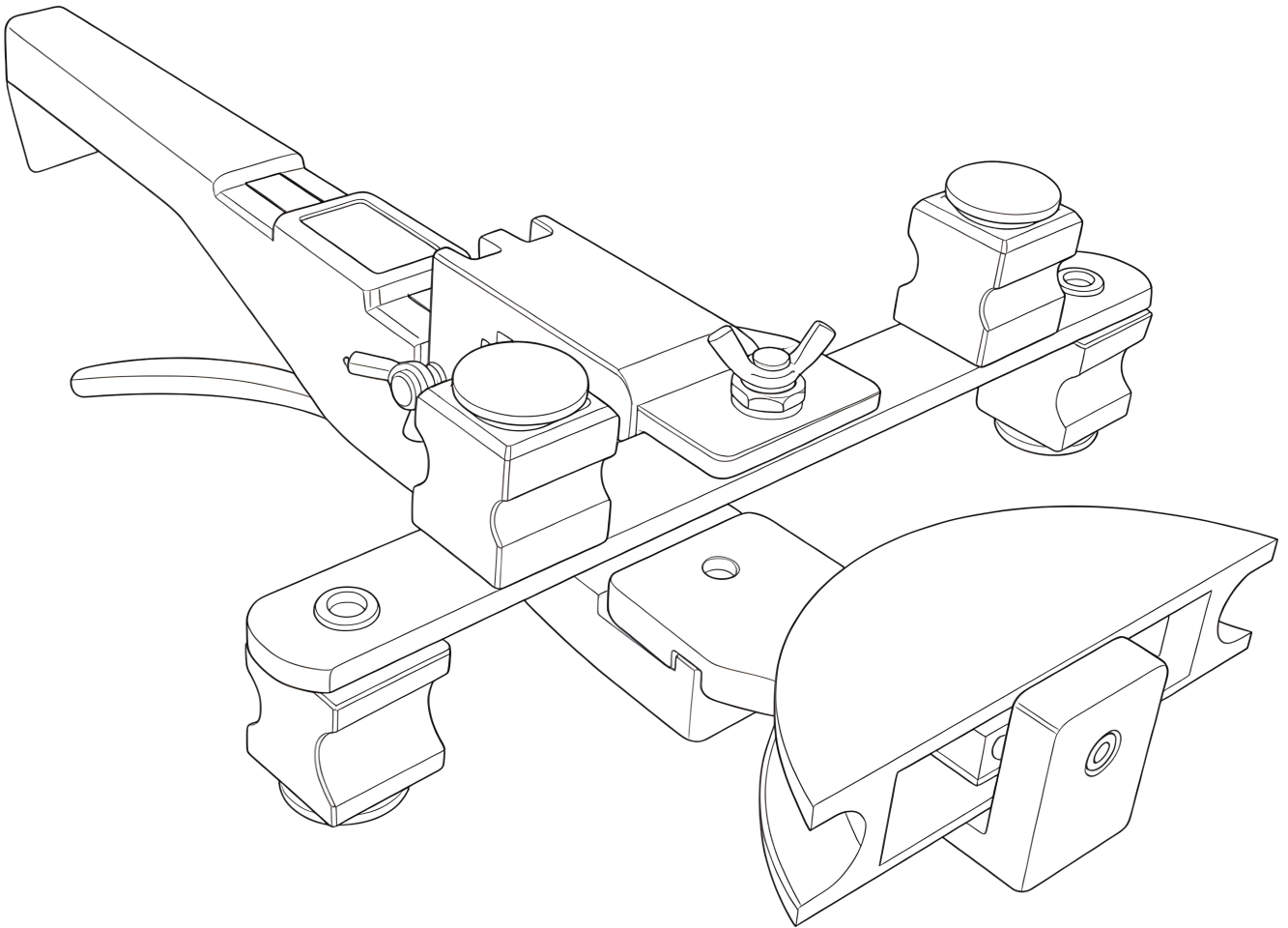

CT-999/RF

For your safety, please read and understand this instruction carefully before you use it. Please keep this instruction in good order. Please give the instruction to the new user when the product is changed.

Product Description

Manufactured by BARTON TOOLS, the 90° Multi Bender Kit (CT-999) is the definitive professional tool for fast, flawless tubing bends. Designed for refrigeration, HVAC, and industrial applications, this kit delivers maximum precision up to a perfect 90-degree angle every single time, transforming complex jobs into simple tasks.

Specifications

Model	Bending Range	Mold Sizes	Wall Thickness	Packing Size
CT-999/ CT-999RF	6–22 mm	1/4", 5/16", 3/8", 1/2", 5/8", 3/4", 7/8" (6, 8, 10, 12, 15, 18, 22 mm)	0.4 – 1.2 mm	420 × 320 × 90 mm

Standard Tube Bending Procedure

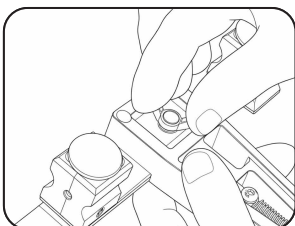

1. **Preparation & Assembly:** Place the universal crossbar onto the housing and tighten it using the wing screw.

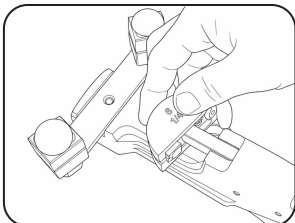

2. **Former Setup:** Select the correct size former (bending wheel) and install it onto the former holder. Rotate the sliding pieces (dented rods) so that the tube groove matches the former slot.

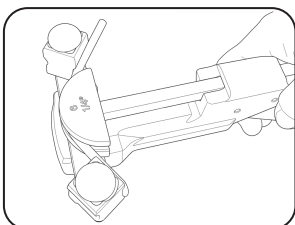

3. **Initiate the Bend:** Place your tube between the former and the sliding pieces. Push the feed lever repeatedly with smooth, steady action. Continue pumping until the tube reaches your desired angle (up to the maximum of 90°).

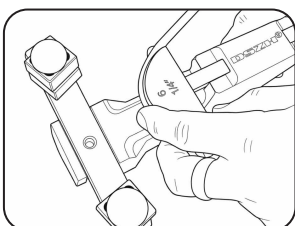

4. **Finish & Removal:** Upright the bender and pull out the feed lever. The universal cross holder and sliding pieces will retract instantly. Carefully remove the bent tube from the slot.

Reverse Tube Bending Procedure

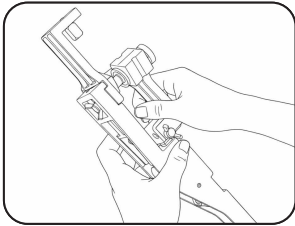

1. **Preparation & Assembly:** Insert the universal crossbar into the dented rod and secure it by tightening the wing screw.

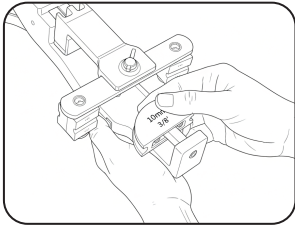

2. **Former Setup:** Select the correct size former (bending wheel) and install it onto the former holder. Rotate the sliding pieces (dented rods) so that the tube groove matches the former slot.

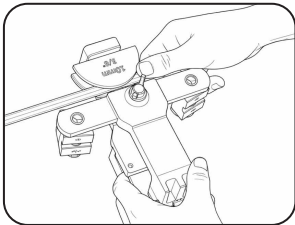

3. **Initiate the Bend:** Place your tube between the former and the sliding pieces. Push the feed lever repeatedly with smooth, steady action. Continue pumping until the tube reaches your desired angle (up to the maximum of 90°).

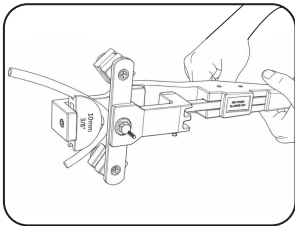

4. **Finish & Removal:** Upright the bender and pull out the feed lever. The universal cross holder and sliding pieces will retract instantly. Carefully remove the bent tube from the slot.

Troubleshooting: Removing a Stuck Tube

If the bent tube is slightly stuck in the former slot after retraction:

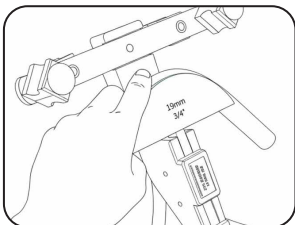

1. Hold the tube with one hand to stabilize it.

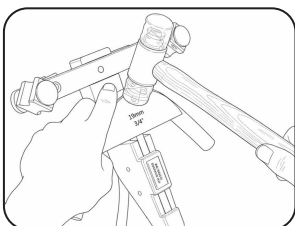

2. Use a non-marring tool (like a soft hammer) to gently strike the former at the indicated position. Do NOT strike the tube to prevent damage.

**BARTON
TOOLS**