

## **SAFETY INFORMATION**

**Failure to observe this warning may result in jury or property damage.**

- The YL-5T Gear Puller will deliver up to 5tons of pulling force, YL-10T up to 10tons, YL-20T up to 20tons , YL-30T up to 30tons and YL-50T up to 50tons. DO NOT use tool on any work piece which cannot withstand the specified amount of pressure.
- Do not drop the tool or expose it to sudden shocks. This tool contains many small components and precision parts. The tool will not operate correctly if sudden shocks from dropping or exposing the tool.
- Do not expose the tool to water, rain, oil or solvents.
- Keep your tool away from excessive heat which tends to weakens the structure of the seal. Do not expose the tool to temperature above 80 degree.
- When it is not in use, the tool should be stocked in dry environment and out of reach of children.
- Hydraulic fluid under pressure. Do not use any parts of body to locate hydraulic leak. Escaping fluid under pressure can cause severe injury or death. If injury results from escaping hydraulic fluid, seek medical attention immediately to avoid serious bodily injury.
- Keep work area clear of unnecessary items. Cluttered area may cause injuries.

## **INSTRUCTION MANUAL**

### **Hydraulic Gear Puller**

### **YL-series**



**Due to continuing improvements, actual product may differ slightly from the product described herein.**

## GENERAL SAFETY RULES

Safety is essential in the use and maintenance of these tools and equipment. This instruction manual and any markings on the tool provide information for avoiding hazards and unsafe practices related to the use of this tool. Observe all of the safety information provided.

1. Work area safety. Keep work area clean and keep children away.
2. Personal safety. Stay alert and use the tool properly.
3. Service. Have your hydraulic gear puller serviced by a qualified service technician using only identical replacements parts.

## USAGE

YL-5T/10T//20T hydraulic gear pullers are designed to pull items such as bearings, pulleys, and chucks from shafts. The Jaws can grip the object from the inside or outside, whichever offers a better grip. The Piston will push on the central shaft while the Jaws pull away. This will remove the item from the shaft by pulling it straight out evenly, without hammering or binding from pulling at an angle.

### 1. Operatiing instruction.

### 5. Illustration-YL-series

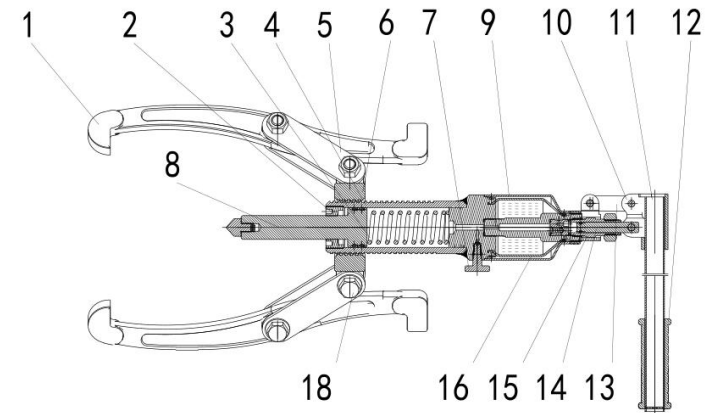

Part	Description	Qty.	Part	Description	Qty.
1	Jaw	3	12	Anti-slip handle cover	1
2	Piston	1	13	Connecting Rod	2
3	Spring	1	14	Pump Axle	1
4	Oil cylinder	1	15	Pump Core	1
5	Connector Plate	6	16	Oil Reservoir	1
6	Puller Sleeve	1	17	Oil Seal	1
7	Return Valve	1	18	Bolt/Washer/Nut Set	6
8	Piston	1			
9	Outer Sleeve	1			
10	Pump Handle Socket	1			
11	Handle	1			



1. Use circlip pliers to remove the circlip



3. Pull the plunger up and out



**4. Limited 1 year warranty.**



2. Open the handle



4. Expose the oil filling port

5. Add hydraulic oil

### 1. Assembly



1. Thread the Puller Sleeve onto the Puller Unit about halfway up the threaded section.

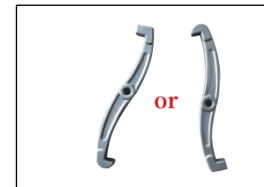

2. Determine if the best grip on the part to be pulled is from the outside or the inside. The hooks on the Jaws face inward when gripping the part from the outside. They face outward when gripping the part from the inside.



3. The jaws have four different settings. Each can be for both inside and outside pulling. Determine whether to use the upper or lower holes in the Jaws and which way the jaws should be turned.

**WARNING!** Turn all the jaws the same way to ensure even pulling.



4. Assemble each of the three Jaws onto the Puller Sleeve using two Connector Plates and two Bolt Sets as shown.



5. Insert the Handle into the Pump Handle Socket.

2. Open Return Valve to fully retract Piston. Close the Return Valve by turning it clockwise until hand tight. Do not overtighten, as this will damage the seal.

3. Place the Jaws around (or in) the item to be pulled. Be sure they will have a firm grip.

4. While holding the Jaws in place, rotate the Puller Unit on the Puller Sleeve, until the end of the Piston contacts the work piece.

5. Pump the Handle up and down to force the Piston down, causing the Jaws to pull upward.

6. Continue pumping the Handle, being sure the Jaws stay in place on the object and the object is not being damaged.

7. In most cases, a certain amount of pressure will build up, and the Gear Puller will suddenly loosen and release. Support the Gear Puller to prevent it from falling.

8. When finished, open the Return Valve by turning it 1 turn counterclockwise (do not remove), and remove the Gear Puller from the workpiece.

9. To prevent accidents, clean, then store the Gear Puller in its case, indoors out of children's reach.

## 2.Specification.

Model	YL-5T	YL-10T	YL-15T
Output	5tons	10tons	15tons
Reach Max.	140mm	160mm	180mm
Spread Max.	200mm	250mm	300mm
Axes travel	50mm	50mm	55mm
Model	YL-20T	YL-30T	YL-50T
Output	20tons	30tons	50tons
Reach Max.	200mm	250mm	350mm
Spread Max.	350mm	400mm	500mm
Axes travel	75mm	75mm	75mm

## 3.Maintain the tool with care.

1) Keep the tool clean for better and safe performance. Dust sand and dirt are harmful to any hydraulic device. The tool must be cleaned with a clean cloth after every use, especially the movable parts.

2) Do not operate the tool if it is damaged, improperly adjusted or not completely or correctly assembled. Check for alignment of moving parts, breakage of parts, mounting and any other condition that may affect its operation. If damaged, it should be properly repaired or replaced by an authorized service facility or distributor.

3) This tool is constructed in accordance with the relevant safety requirements. Repair should be carried out by qualified person using original spare parts, otherwise the repair may result in considerable danger to the user.

4) When replacing hydraulic oil, please add No.15 hydraulic oil.