

Instruction Manual

Integral Hydraulic Puller

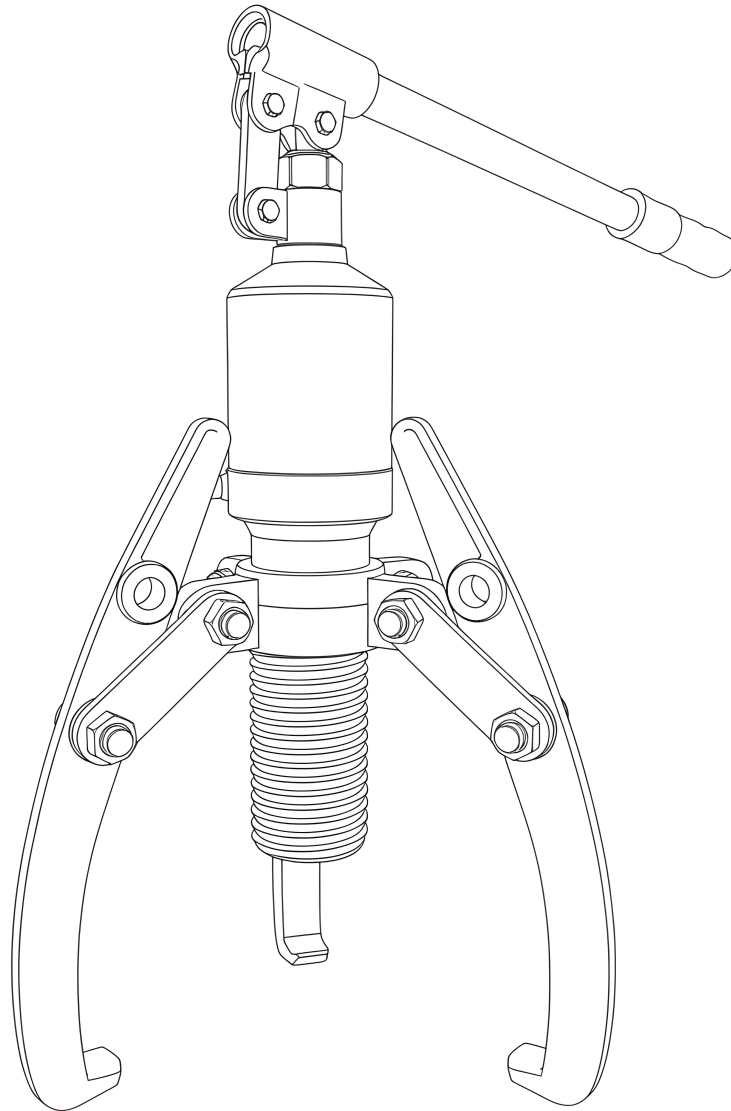

YLX Series

For your safety, please read and understand this instruction carefully before you use it.
Please keep this instruction in good order. Please give the instruction to the new user
when the product is changed.

Product Description

This puller is a new ideal tool for replacing mechanical transmission with a puller.

- **Features:** The product is convenient to use and is not limited by the site. It is compact in structure, flexible in use, light in weight, small in size, and convenient in carrying.
- **Application:** It is suitable for hardware, machinery, and electric power repair places.
- **Working Principle:** The hydraulic puller comes in two types: the integral and the split type. It uses oil pressure to start the rod moving forward directly. The claw sleeve can be adjusted directly and moved backward along the thread.

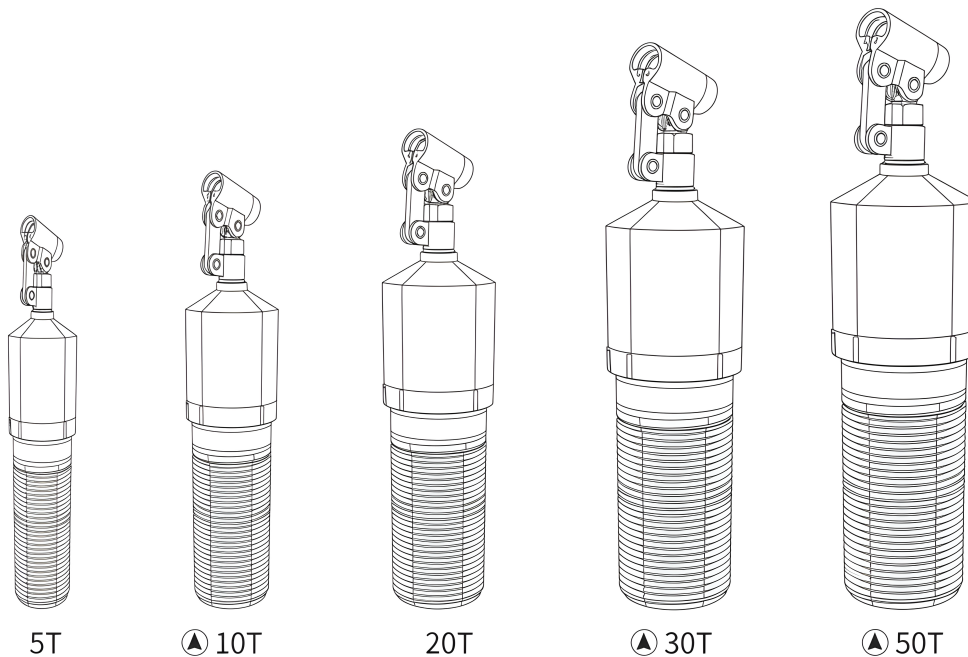

Model	Output	Reach Max	Spread max	Axes Travel
YLX-5	5T	190mm	250mm	50mm
YLX-10	10T	220mm	310mm	60mm
YLX-20	20T	265mm	420mm	70mm
YLX-30	30T	295mm	485mm	60mm
YLX-50	50T	300mm	600mm	60mm

Operating Instructions

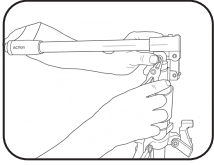

1. Before Use: Tighten the oil return knob in a clockwise direction.

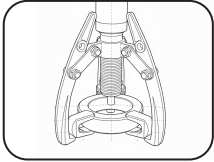

2. Setup: Adjust the puller cover to the claw and grab the object to be pulled.

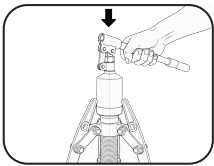

3. Operation: Insert the handle into the press hole to move up and down. The piston rod moves smoothly, the grips retract, and the object is pulled out.

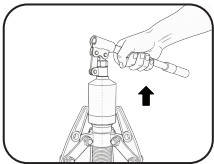

4. Recycling: After the operation, the oil knob is loosened and the piston is returned.

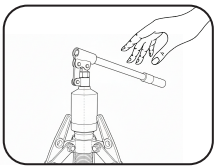

5. Re-attempting: If the piston rod does not pull out the object during the working stroke, you should stop working, release the oil knob to let the piston rod return.

Important Precautions

1. Overloading: Select a hydraulic puller with the appropriate specifications for the object to be used, and avoid overloading to prevent damage.
2. Piston Rod Extension: The extension distance of the puller piston rod must not exceed the specified value in the performance parameter table.
3. Red Marking Line: When using, please pay attention to the extreme position of the red marking line on the piston rod after it is exposed, and the work should be stopped.
4. Cylinder End: It is strictly prohibited to use past the end of 15mm, otherwise it may cause damage.
5. Quick Joint: In case of load, avoid quick joint dismounting to prevent accidents and damage to parts.
6. Temperature and Oil:
 - The hydraulic puller is suitable for use in -5°C to 45°C .
 - For -5°C to 45°C , use Hydraulic Oil ISO VG #15 - #46

General Maintenance

1. **Cleanliness:** This machine uses oil as the medium, and you must maintain the cleanliness of the oil and the machine to prevent clogging or oil leaks, which would affect the usage effect.
2. **Air Removal (New or Long-Standing Pullers):** New or long-standing hydraulic pullers may have more air in the oil cylinder. This can cause the piston rod to have a small jump phenomenon when used. To remove the air, run the hydraulic puller with an empty load 2-3 times.
3. **Monthly Maintenance (Long Idle Pullers):** A long-idle puller's seals may harden from not working for a long time, affecting the puller's life. If the puller is not used for an extended period, you should run it with an empty load 2-3 times a month.
4. **Air Beating/Cavitation:** If there is an air beating phenomenon during use, first relax the oil setting screw on the pump body. Turn the pump body vertically head down to empty a few times, and then tighten the oil screw. The puller can then continue to be used.

